

EXPLODED VIEWS

1. CABINET AND MAIN FRAME SECTION

5

4

3

2

1

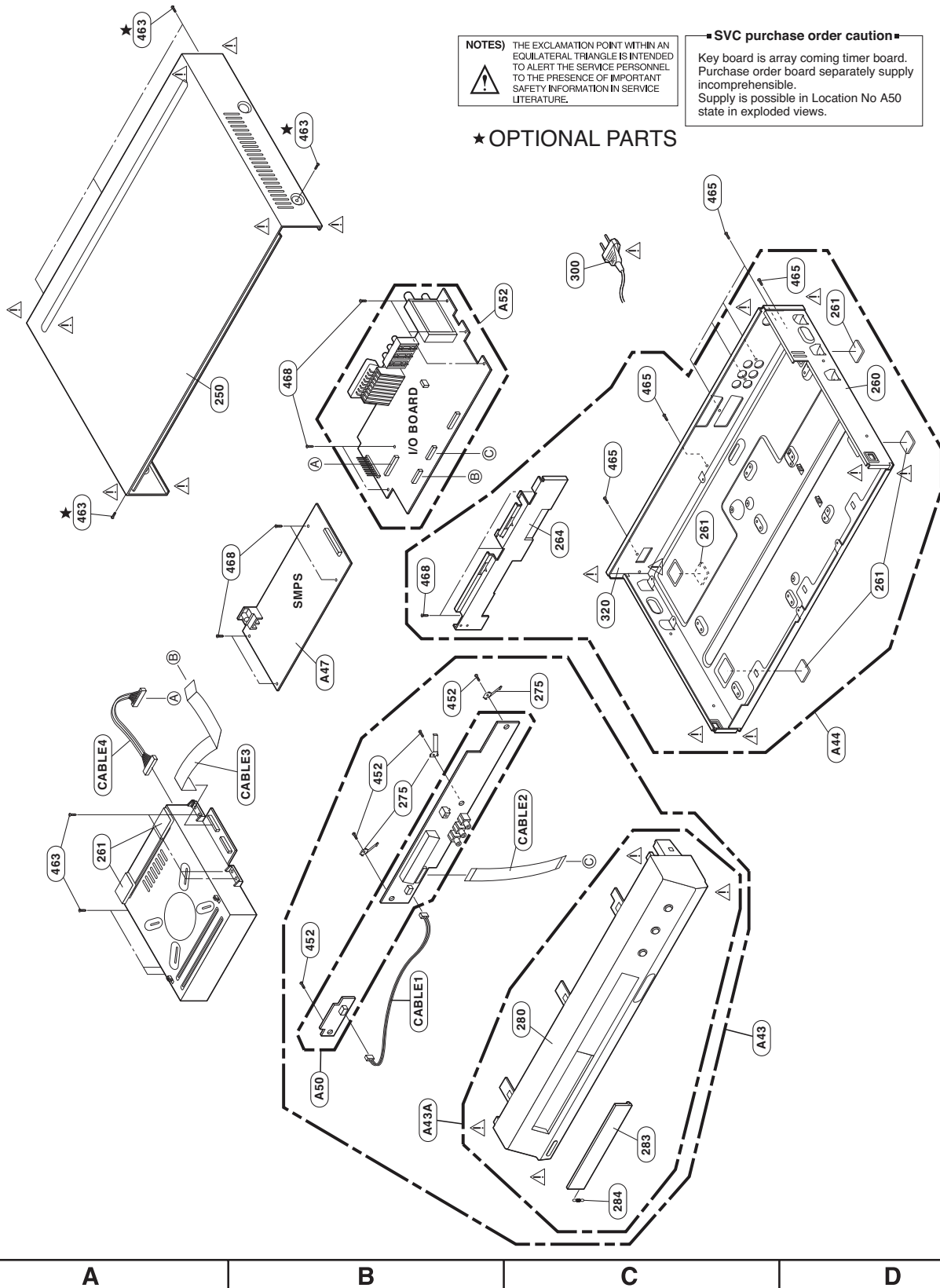

NOTES) THE EXCLAMATION POINT WITHIN AN EQUILATERAL TRIANGLE IS INTENDED TO ALERT THE SERVICE PERSONNEL TO THE PRESENCE OF IMPORTANT SAFETY INFORMATION IN SERVICE LITERATURE.

■ SVC purchase order caution ■
Key board is array coming timer board. Purchase order board separately supply incomprehensible. Supply is possible in Location No A50 state in exploded views.

★ OPTIONAL PARTS

A

B

C

D

[illegible]

3. PACKING ACCESSORY SECTION

